

For reference only. See data sheet for the detailed specifications.

Technical Specification

Frequency Range(GHz)	12.4 – 26.5
Waveguide	WR51
Gain(dBi)	20 Typ.
Polarization	Dual Linear
3dB Beamwidth(deg)	E Plane: 13 Typ.
	H Plane: 13 Typ.
Cross Pol. Isolation(dB)	40 Typ.
Port to Port Isolation(dB)	50 Typ. ; 40 Min.
VSWR	A Type: 1.80:1 Typ.
	C Type: 1.80:1 Typ.
Output	A Type: FBP180(UBR180) (Modified with 4xM4 Deep 8)
	C Type: 3.5mm-Female or SMA-Female
Material	Al
Finish	Gold Plated and Silver Plated, Gray Paint
Size(mm)	A Type: 110.1 x 110.1 x 408.8
	C Type: 125.9 x 110.1 x 453.3
Net Weight(Kg)	A Type: 1.94 Around
	C Type: 2.25 Around

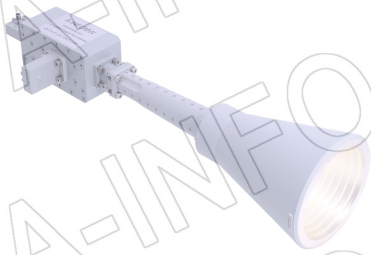

Outline Drawing (Size: mm)

FBP180 Output (P/N: LB-CH-51-20-T56-A)

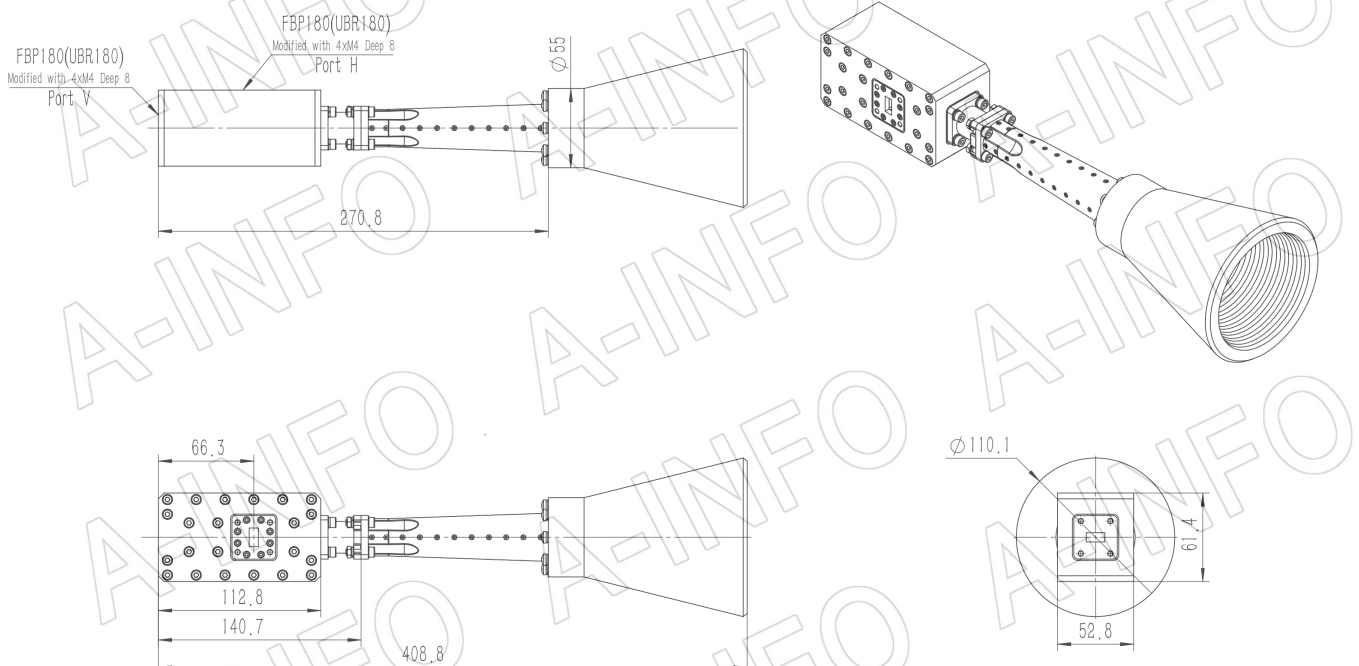

3.5mm-Female Output (P/N: LB-CH-51-20-T56-C-3.5F)

For SMA-Female output outline drawing, please contact A-INFO.

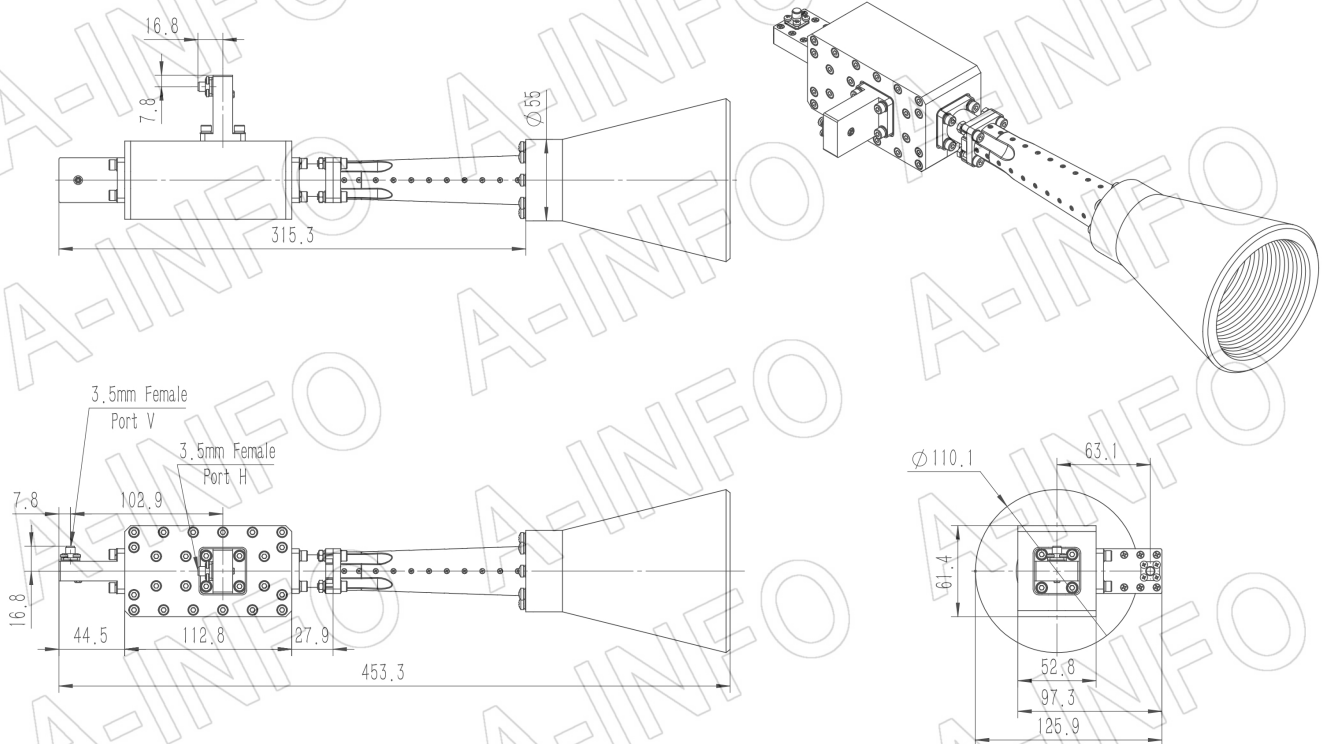

Flange Drawing (Size: mm)

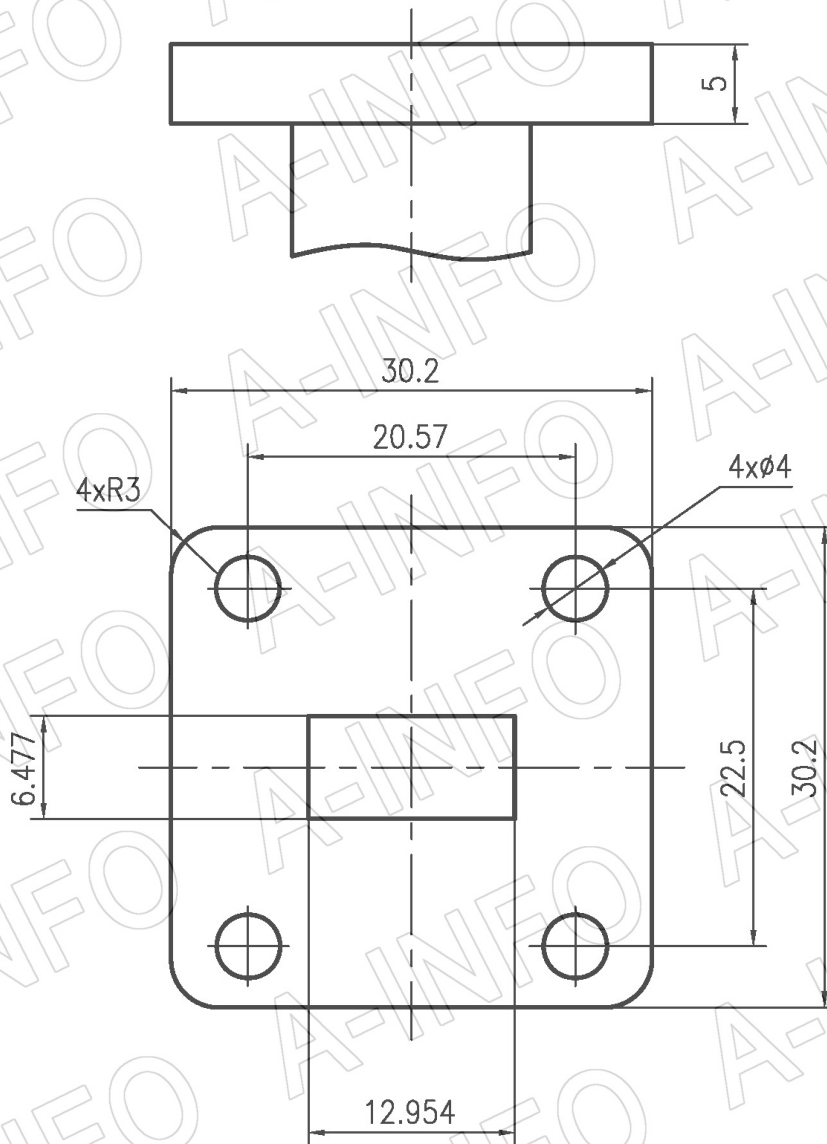

FBP180

Test Results

1. Gain & Antenna Factor

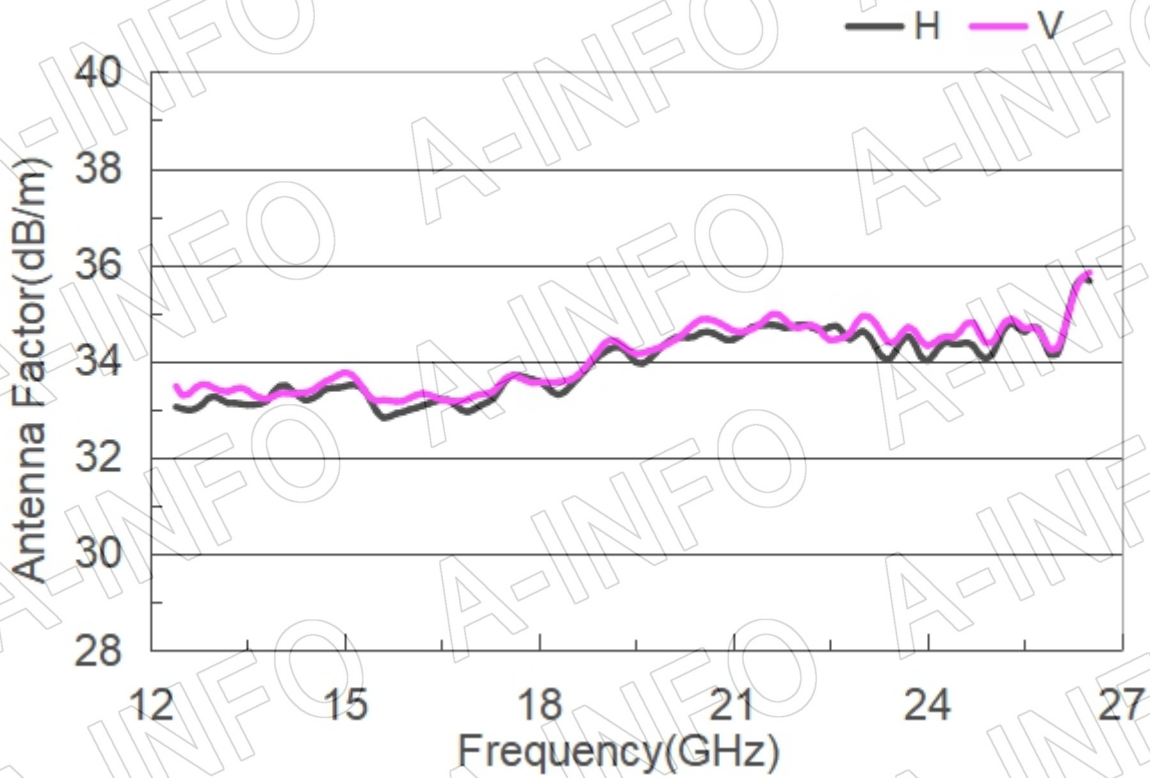
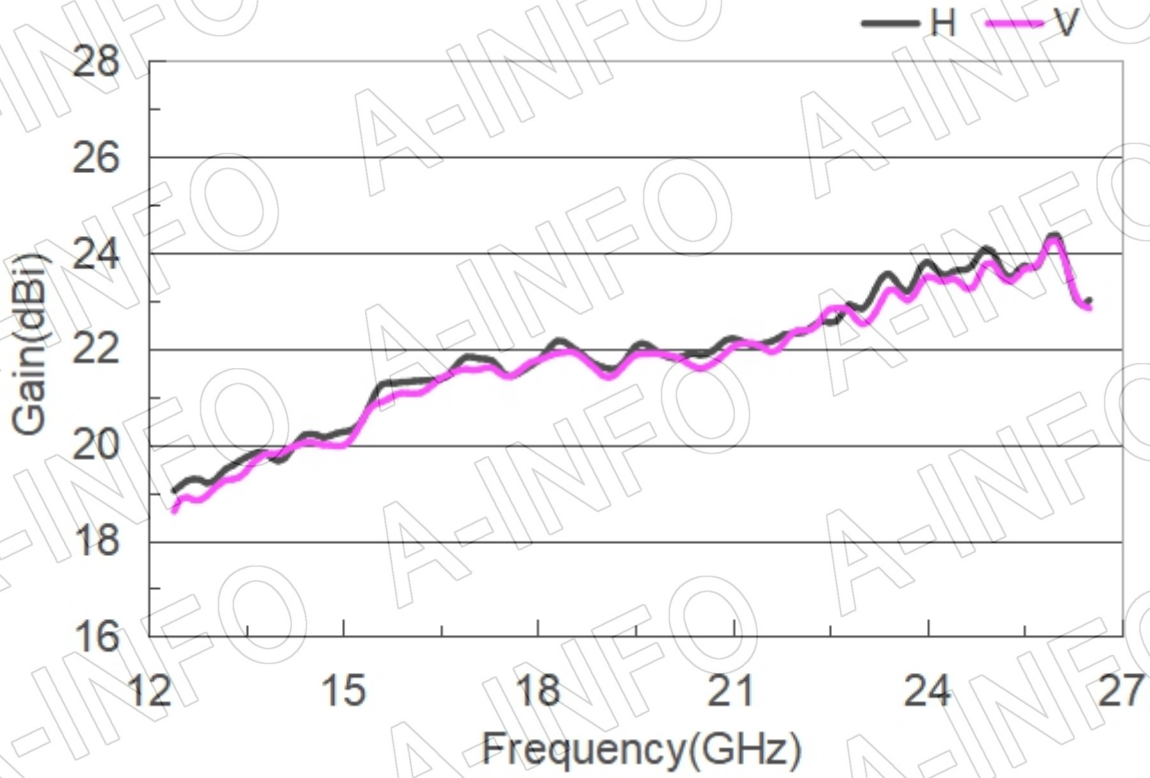

2. Cross Polarization Isolation

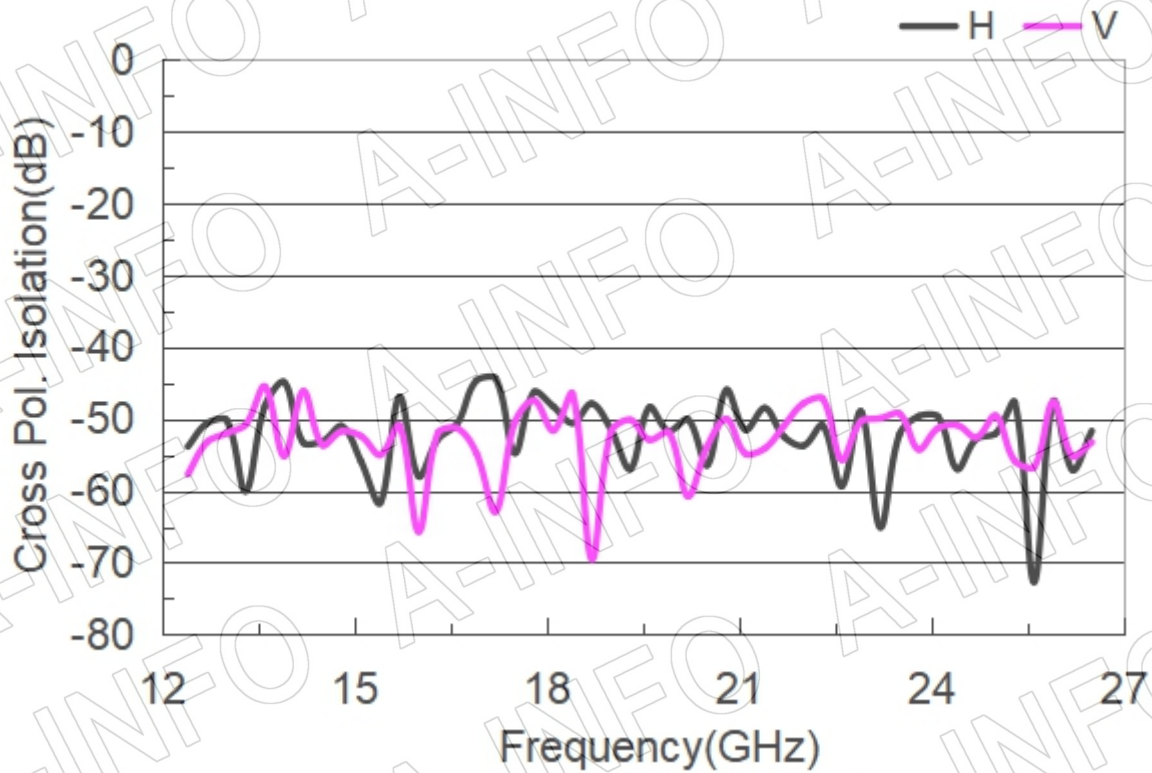

3. Port to Port Isolation

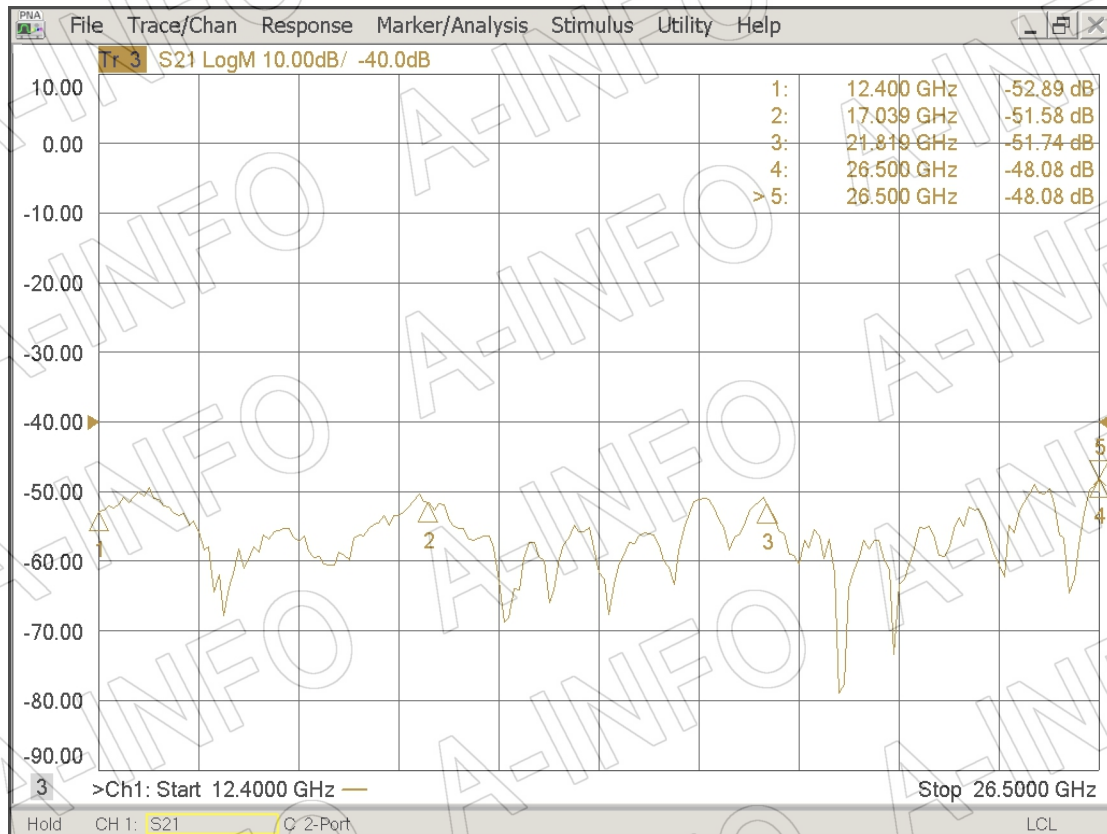

4. VSWR_A Type

Port-H

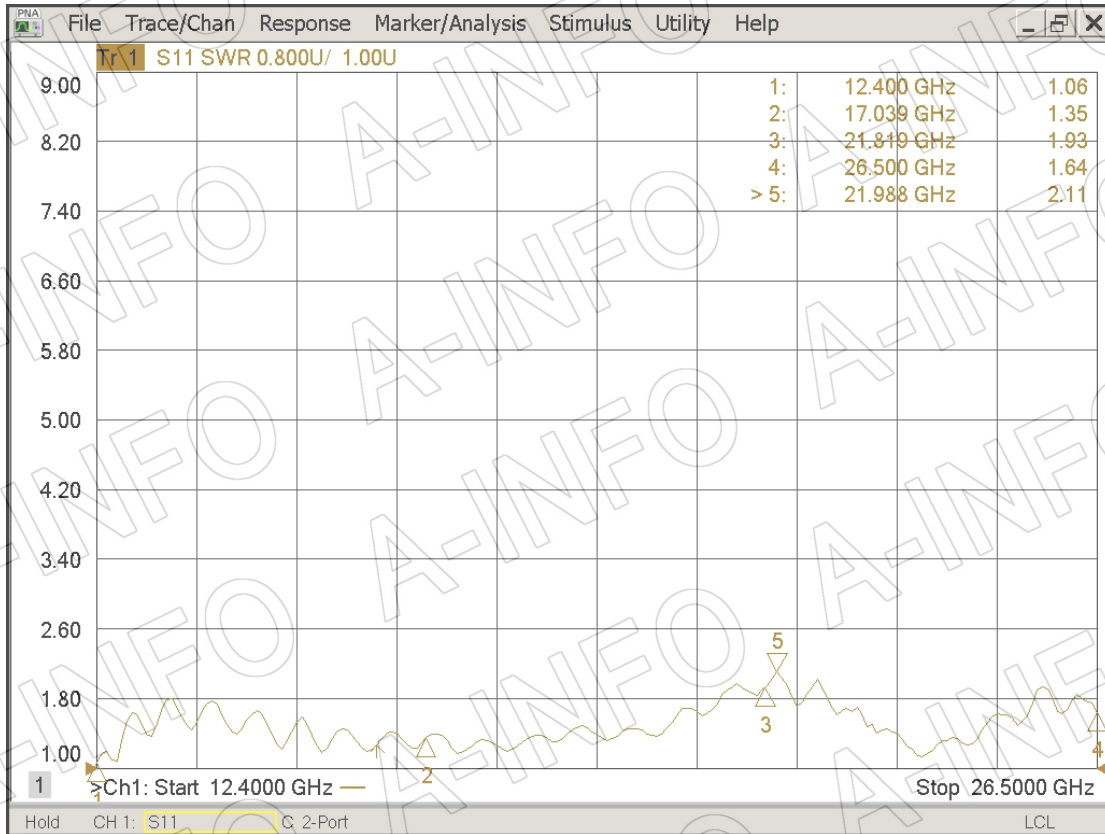

Port-V

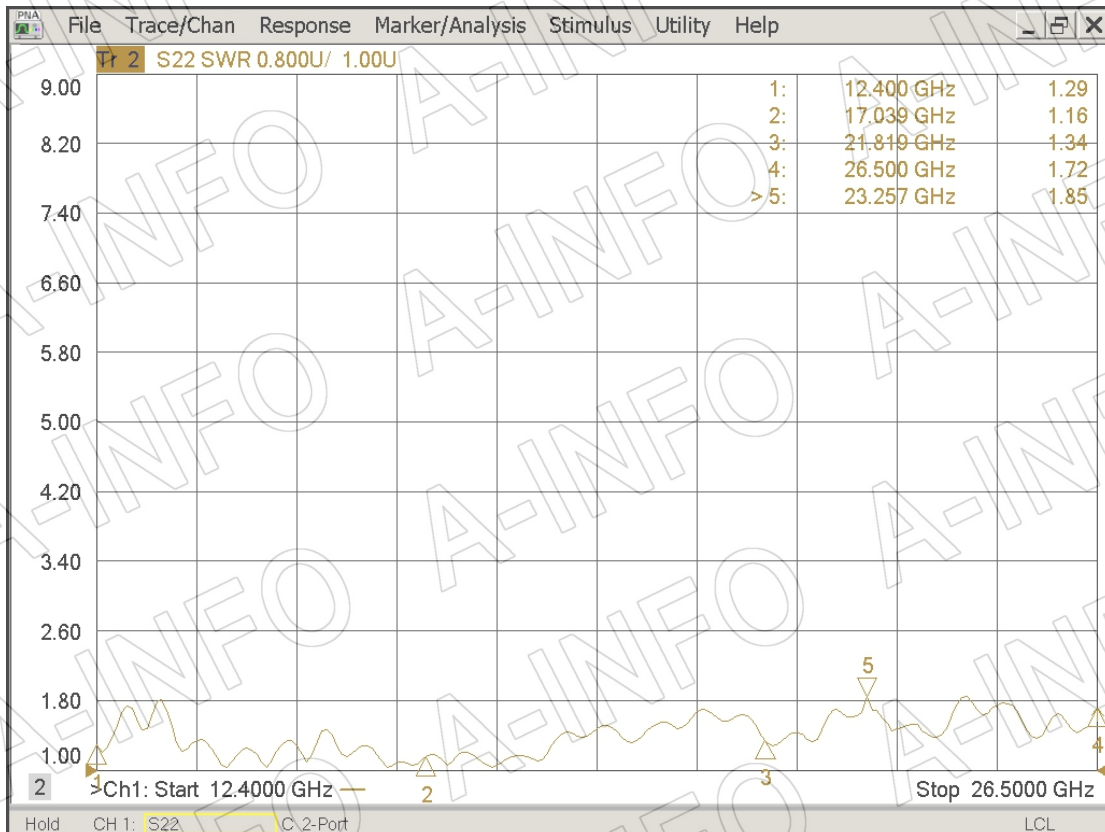

VSWR_C Type

Port-H

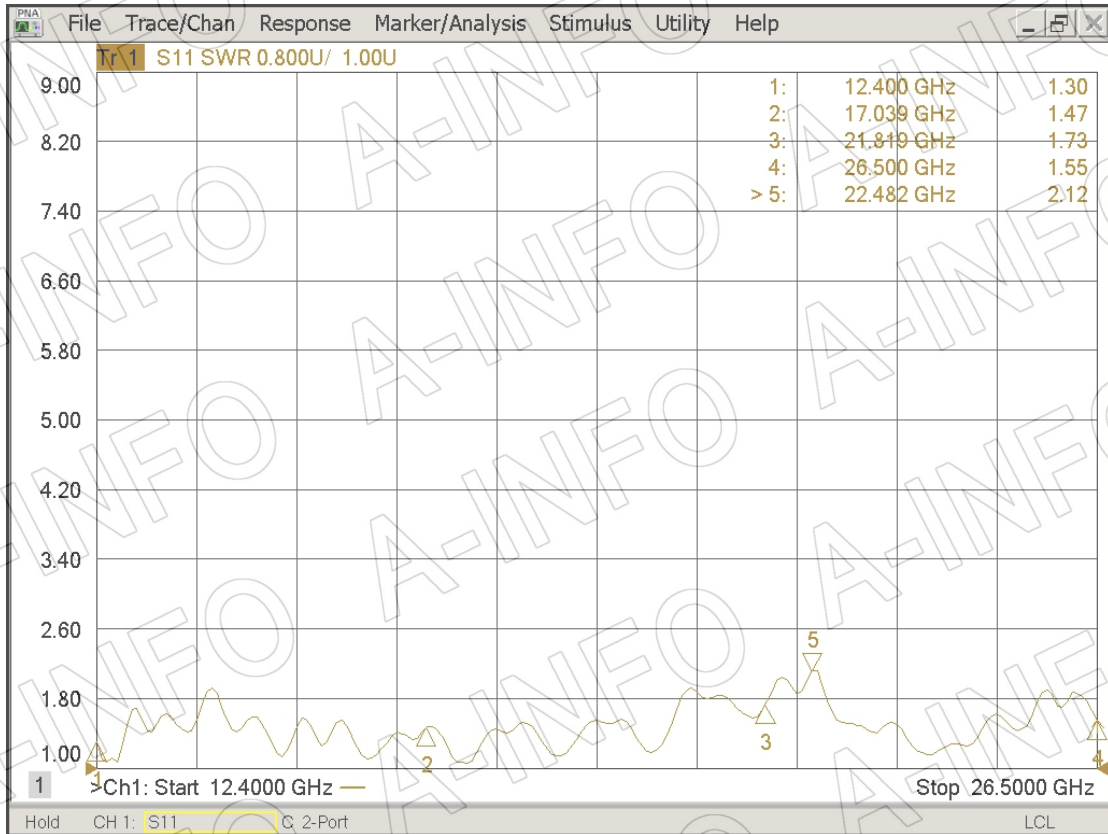

Port-V

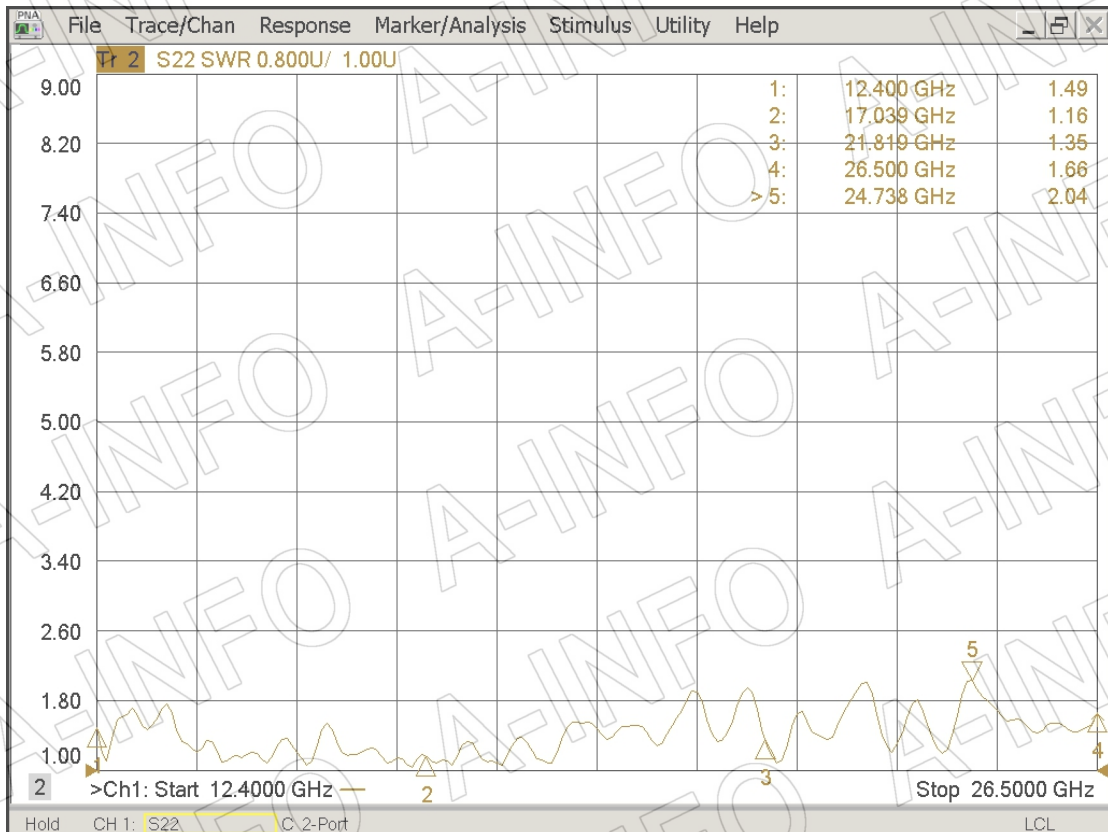

5. Pattern

